

SA8210X-1

freestanding/built-in dishwasher

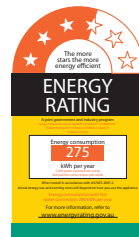

also available in white
code: SA8210W-1

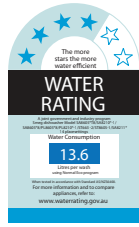

QUIETNESS

Into the new polycarbonate plinth is infused the steel carcass enclosing the wash tank for improved stability and low vibration. Within this plinth, shock absorbing dampeners for the motor and pump and a new PVC capillary-connector system ensures the suppression of any remaining noise.

The interior design of the continuous stainless steel tank walls allows for the easy flow and deflection of water jets. Again, this diminishes noise. Exterior walls of the tank are tar sealed and then overlaid with compacted foam and rockwool blanketing, all to reduce noise. The resulting sound level of the dishwasher, when operating, is barely perceivable.

FIVE STAGE WATER SECURITY

- 1 **Anti reflux** — Before entering the wash chamber the water passes through a syphon break, ensuring there is no water refluxing to the mains water supply.
- 2 **A water level pressure switch** detects the exact amount of water required and then starts washing.
- 3 **A safety pressure switch**, positioned slightly higher in the sump, detects any excess water, stops the water fill and starts the pump out.
- 4 **Pex hosing**, an ultra-resilient conduit, is used for water intake. Finally, fail safe ...
- 5 **Brass-threaded connectors** (instead of plastic), not subject to expansion and compression, will not crack, infinitely longer wearing.

PRACTICALITY

Whether it be for a very busy household or for a single person who is rarely home, simply choose the appropriate program. Importantly, do not waste your time and water preparing the items for the dishwasher. Wipe off larger food scraps and place immediately into dishwasher. If a small load, select the 'Rinse and Hold' (Program 1), for only seven litres water consumption.

Repeat this selection as many times as necessary as you progressively load in more servings. When full, finish off with the Delicate wash.

A very dirty, dried-on load may require Normal or Super wash. Again, no unnecessary preparation is required. There are another three programs from which to choose.

SELF-CLEANING FILTER

Water is drawn through five filtering stages and, through the constant recirculation, food matter is broken down into a superfine paste small enough to pass through the final stainless steel micromesh. This waste is isolated from the ongoing washing or rinsing cycle. 'Dirtied' water is emptied at the end of each cycle stage. Larger inorganic and undissolvable matter, such as bones, is isolated onto the initial filter from which it is easily retrieved. To assist, there is a dedicated downward waterjet off the lower wash arm directing dislodged food debris toward the filtering system.

RESIDUAL HEAT HOT AIR DRYING

All wash programs finish with a final hot rinse at 68° or 70° Celsius leaving the wash tank, after draining, with a very high residual heat. The superior multi-insulation helps maintain this heat. With the addition of the polish additive (generically 'rinse aid') water will not adhere to any surface, enabling fast drainage and subsequent fast drying.

ERGONOMIC

A new 'east-west' lower basket configuration allows for easier accessing and, when the top basket is raised, more 30cm diameter plates can be washed. The all-pronged lower basket also caters for extra loading of long-stemmed glasses, tumblers, mugs etc. The rear racks are collapsible to accommodate awkward utensils, such as platters and saucepans.

In the top basket, with the absence of the intrusive water funnel (the SA8210X-1 has rear-fed water to the top spray arm) the now spacious and uninterrupted area accommodates larger unconventional shapes such as platters and woks. For extremely large utensils, simply remove the top basket.

Installation	freestanding — 600mm total depth built-in with worktop lid removed — 570mm total depth
dimensions	850mmh x 600mmw x 600mmd with lid attached
capacity	14 placesettings (IEC international)
wash action	orbital — three wash arms upper polypropylene lower stainless steel
programs	four wash cycles one exclusive rinse selection
delay start	3-hour, 6-hour, 9-hour selections
wash temps	40°C, 55°C, 65°C and 70°C rinses at ambient, 68°C and 70°C
half load	top basket on four wash programs, separate cutlery basket
water connection	cold or hot
drying	residual heat hot air
quietness motor	53 dba sound pressure at main (wash) 41 db installed and operating
anti-flood motors	five-stage water security wash/rinse motor 150 watt drain pump 20 watt heating element 2100 watt concealed
accessory	worktop/lid fitted — removable
warranty	two years parts and labour

SA8210X-1

built-in/freestanding dishwasher

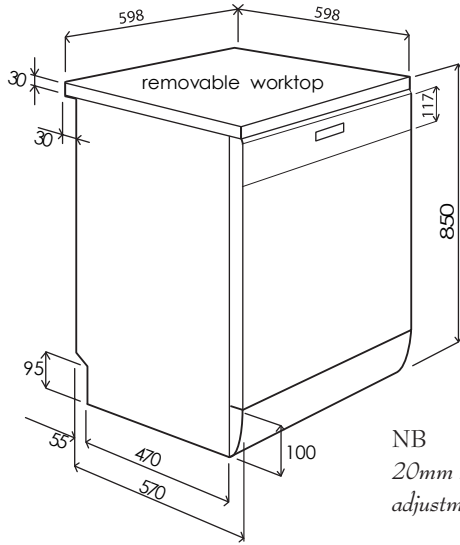

NB
20mm high feet
adjustment if required

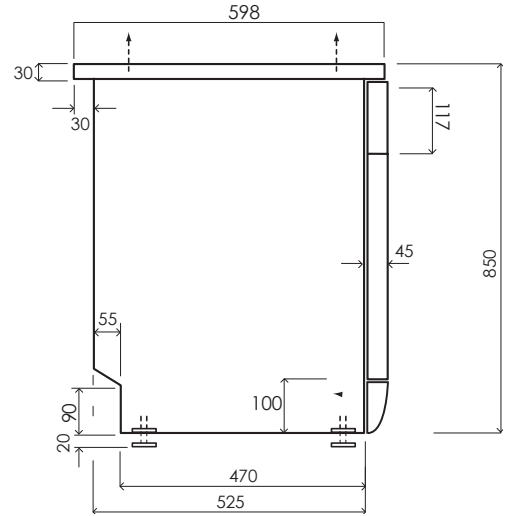

SIDE ELEVATION

Program	Description	Symbol	Action						Time minutes
			prewash	wash	cold rinse	hot rinse	residual heat drying	half-load selection top basket	
SOAK	rinse and hold progressive loading		●						12
NORMAL ECO	pots, dishes without dry residue, not very dirty		●	40°C	1	68°C	●	yes	117
ECO	pots, dishes with dry residue, not very dirty	Eco		55°C	2	68°C	●	yes	150
NORMAL	normal dirty pots, dishes with dry residue, starch		●	65°C	1	68°C	●	yes	95
SUPER	very dirty pots, dishes with dry residue, starch		45	70°C	2	70°C	●	yes	115

NB: wash program durations can be substantially reduced if hot water connection is practicable

Water mains pressure allowed —

minimum	maximum	electricity supply	240 volt 50 Hz
5Ncm/2	1000Ncm/2	electricity connection	10 Amp GPO
50Kpa	1000Kpa	concealed element	2100 Watt
3psi	110psi	wash motor	150 Watt
0.5bar	10bar	pump motor	20 Watt
Suitable for mains, gravity feed and tank pressures		max current	9.4 Amp

PACKAGED —

dimensions 890 x 705 x 655 = 0.41m³
gross weight 60kg
net weight 51.3kg

Water connection hot or cold

Pex hose tolerance	90°C
Recommended max intake	65°C

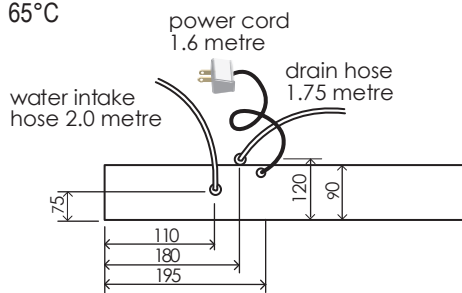

REAR ELEVATION — UTILITIES

DRAIN HOSE

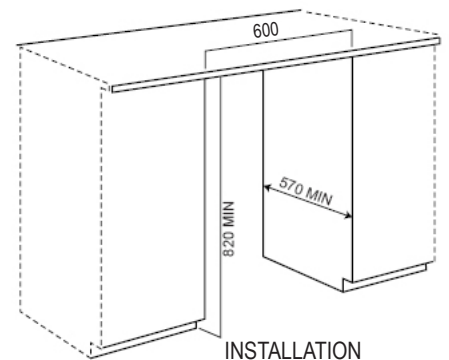
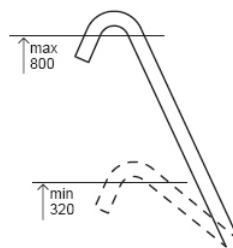

INSTALLATION

WARNING: technical specifications and product sizes can be varied by the manufacturer, without notice. Cutouts for appliances should only be by physical product measurements. The above information is indicative only.