

Operating Instructions

Washing Machine

Dear Customer,

Thank you for choosing this quality product from ASKO.

We hope it will meet your expectations and fulfil your needs for many years to come. Scandinavian design combines clean lines, everyday functionality and high quality. These are key characteristics of all our products and the reason they are greatly appreciated throughout the world.

To get the most from your new machine, we recommend that you read the operating instructions before using the machine. The operating instructions also include information on how you can help protect the environment.

ASKO W6444

 **ASKO**

Contents

Before using your machine for the first time	4	Washing	11
Transport protection	4	Sort your laundry.	11
Packing material	4	Turn on the main power switch	11
Washer door	4	Open the washer door and load the washing	11
Checking water hardness	4	Add detergent and fabric softener, as required	11
Safety instructions	5	Select the program	12
General	5	Select options	15
Installation	5	Close the washer door and press the Start/Stop button	16
Overflow guard function	5	Once the program has finished	16
Transport/Winter storage	5	Settings	17
Recycling	5	You can change the following settings:	17
Child safety	6	Door opening	17
Keep an eye on children!	6	Extra rinses	17
Description of the washing machine	7	Care and cleaning	18
Detergent compartment	7	Cleaning the trap and the drainage pump	18
Advice and tips before washing	8	Cleaning the detergent compartment	18
Sorting your laundry	8	Cleaning the outside of the machine	18
Clothing	8	Cleaning the inside of the machine to avoid unpleasant smells	19
Laundry labels	8	Rinse holes under the agitator	20
Laundry label symbols	8	If you have hard water	20
Coloured cotton	8	Troubleshooting	21
Unbleached linen	8	The washer door will not open	21
Wool	9	The machine will not start	21
Rayon fibres and synthetic fibres	9	Error messages	22
Reducing allergic reactions	9	Technical information	23
Save time and energy	9	Technical data	23
Economy and efficiency	9	Information for test institute	23
Detergents	9	Transport protection	25
Dyeing fabrics	9		

Contents

Installation	27
Positioning the washing machine	27
Adjusting the feet	27
Connection to water supply	27
Drainage connection	28
Electrical installation	28
Service	29
Before contacting the service division	29
Quick guide	32

Before using your machine for the first time

Transport protection

Remove any transport protection devices before installing the machine. See the "Transport protection" chapter.

Packing material

Sort waste materials in accordance with local guidelines.

Washer door

- The washer door will not open until the machine is connected to the electricity supply.
- To open the door manually, see "The washer door will not open" in the "Troubleshooting" chapter.
- The machine cannot be started when the door is open.
- To open the washer door while a program is running, see "Close the door and press the Start/Stop button" in the "Washing" chapter.

Checking water hardness

The quantity of detergent needed depends, amongst other things, on how hard the water is. See the detergent pack for details. Phone your local water company to check the water hardness in your area.

NOTE!

Each machine is tested before leaving the factory. A small amount of water may remain in the drain pump, though this does not affect quality or damage the machine.

See Quick guide on the last page

Safety instructions



General

- Read the operating instructions and keep them in a safe place.
- Installation should be carried out by qualified ASKO technicians.
- The machine should only be used for washing items as described in these instructions. It is not intended for dry cleaning.
- Use only detergent intended for machine washing!
- Remove any transport protection devices before using the machine. See the "Transport protection" chapter.
- Repairs and maintenance must be carried out by a qualified professional.
- Damaged mains cables must only be replaced by a qualified electrician.
- The machine is not designed to be used by persons (even children) that are physically or mentally handicapped or lack experience and knowledge. Such persons must receive instruction in how to use the machine or be supervised by a person responsible for their safety.
- Children must be watched to ensure they do not play with the machine.
- In the enclosed plastic bag you will find a tool for opening the washer door in emergencies.

Installation

See the "Installation" chapter.

Overflow guard function

If the machine's water level rises above the normal level, the overflow guard function begins to pump water out and shuts off the water intake. If the water level has not dropped within 60 seconds, the program is terminated.

Transport/Winter storage

If the machine is to be transported or stored in unheated premises where the temperature can fall below freezing, do as follows:

- Empty the filter and the drainage pump. See the "Care and cleaning" chapter.
- Shut off the water to the washing machine, loosen the supply hose to the intake valve and let the water run out from the valve and hose.
- After emptying the pump, a small amount of water may remain in the machine. This does not affect quality or damage the machine.

Recycling

This machine is manufactured and labelled for recycling. In order to prevent injuries, the machine must be made unusable once the decision has been taken to dispose of it. Contact your local authority for information about where and how your machine can be recycled correctly.

Child safety

Keep an eye on children!

- Always close the door and start the programme immediately once you have added detergent.
- The appliance is not intended for use by young children or infirm persons without supervision.
- Young children should be supervised to ensure that they do not play with the appliance.
- Store detergent and fabric softener out of the reach of children!

CAUTION!

If this appliance is supplied from a cord extensions set or electrical portable outlet device, the cord extension set or electrical portable outlet device must be positioned so that it is not subject to splashing or ingress of moisture.

Description of the washing machine

1. Main power switch
2. Detergent compartment
3. Program panel
4. Serial number plate (on inside of washer door)
5. Drainage pump cover
6. Drainage pump (behind cover)
7. Washer door

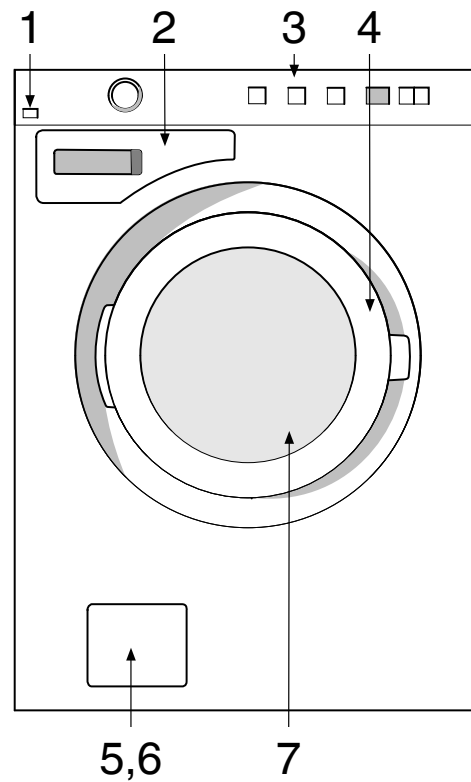

Detergent compartment

1. Pre-wash
2. Main wash
3. Fabric softener

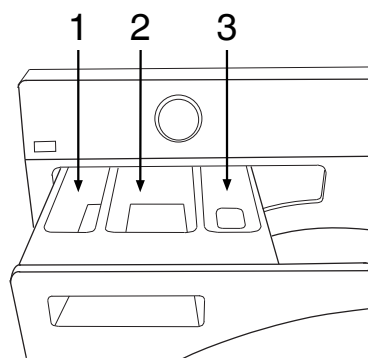
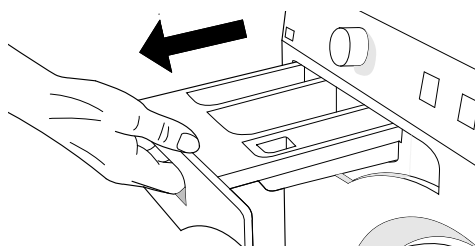

Advice and tips before washing

Here are some tips that may help you before washing.

Sorting your laundry

Sort items according to:

- how soiled they are
- colour
- material

Clothing

1. Do up zips and close Velcro straps so that they don't harm fabrics.
2. New coloured items may contain excess dye and should therefore be washed separately the first few times.
3. Turn delicate items inside out. This reduces the risk of burling and fading.
4. Empty pockets and wash them inside out if possible.

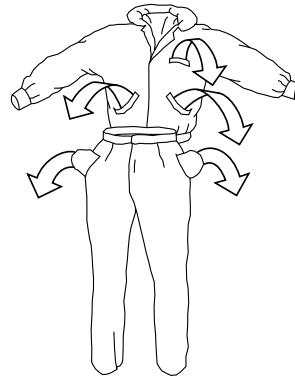







Laundry labels

Look at the item's laundry label. The table below shows suitable wash programs for different materials and wash loads. Using modern washing machines and detergents, for example compact detergents, you can usually wash at lower temperatures. It is a good idea to use trial and error to find out what produces the best results.

Laundry label symbols

Examples of washing instructions and recommended programs. Always follow the washing instructions for each garment.

Laundry labels	Material	Program	Load
	Cotton, linen, white and light-coloured items.	Colour/White 60 °C to 95 °C	1/1 drum
	Cotton, linen, cotton/polyester. Light and dark-coloured garments.	Quick 60 °C	1/1 drum
	Polyester, polyamide, elastane, acrylic. Light and dark-coloured garments.	Synthetics 40 °C	1/1 drum
	Acrylic, viscose, modal, acetate.	Easy Care 40 °C	1/2 drum
	Silk and very delicate items	Synthetics 30 °C	1/3 drum
	Wool and other very delicate garments	Wool/hand wash 30 °C to 40 °C	1/3 drum

Coloured cotton

Coloured cotton items with the washing instruction 60 °C should be washed at 60 °C for the first time in order to remove any excess dye. If you do not do so, there is a risk that the colour will run. Use detergent without bleach in order to preserve the colour of the fabric.

Unbleached linen

Unbleached linen fabrics should be washed at 60 °C, using detergent containing no bleach or optical whiteners. Heavily-soiled linen can occasionally be washed at higher temperatures, but not too often because the heat can destroy the linen's shine and strength.

Advice and tips before washing

Wool

These fabrics are labelled either machine wash or hand wash. The Wool/hand wash program is at least as gentle as washing by hand.

Wool is especially sensitive to processes such as washing.

If you do not wish to spin dry, you can squeeze out the water using terry towels. In this case select No spin.

To find out how to choose this setting, see the "Washing" chapter. However, most garments can withstand a short spin. Choose a short spin by selecting a spin speed of 800 rpm or less.

Rayon fibres and synthetic fibres

Materials made of rayon fibres, such as viscose, and some synthetic fibres are very delicate and require much space so as not to crease. Only half fill the drum when washing and choose a spin speed of 800 rpm or lower.

NOTE!

Viscose and acetates are fragile when wet.

Reducing allergic reactions

The washing machine has a Super Rinse option. Use this for people with sensitive skin, such as those with allergies and small children.

Save time and energy

Use the Colour/White program to save time and energy. This program has a shorter main wash than Normal, but is often sufficient for lightly soiled washing.

Economy and efficiency

You can save energy by not using higher temperature programs than necessary.

- Select Quick if you just need to freshen up shirts or exercise clothes, for example. This will save both water and energy.
- If you select a fast spin speed, this reduces energy consumption when drying in a tumble dryer or drying cabinet.
- Always wash with a full load when using the Heavy, Colour/White and Normal programs.
- Avoid pre-washing. Modern machines and detergents clean effectively without pre-washing. Pre-washing is only necessary for heavily soiled washing.

Detergents

Eco-labelled detergents are less harmful to the environment.

Detergent overdosing does not give better washing results; it merely causes a greater impact on the environment; can also hinder the wash performance.

Try to use less detergent, and increase only if you are not satisfied with the results.

Dyeing fabrics

If you want to dye fabrics in the machine, select the Colour/White program with the Super Rinse option. Select temperature according to the dye manufacturer's recommendations.

Choose a low spin speed if the fabric to be dyed is a blended material such as polyester/cotton.

NOTE!

Add the dye directly to the washing drum – not to the detergent compartment. After dyeing, you should run the machine empty using the same program. Use the normal amount of detergent.

Advice and tips before washing

NOTE!

Due to environmental concerns, we discourage the use of strong chemicals.

When using agents for bleaching or stain removal, there is a risk of rust (corrosion) and discolouration of the machine.

Washing

1 Sort your laundry.

See the "Advice and Tips before washing" section.

Place underwired bras in a laundry net.

Empty pockets. Coins, nails and the like can cause damage to the machine and fabrics. See the "Advice and Tips" section before washing.

2 Turn on the main power switch

3 Open the washer door and load the washing

If the washer door is closed, press the Door opening button (key symbol). The door opens once all water has drained from the machine. Load the washing. The wash program chart shows how much washing can be washed with each program.

4 Add detergent and fabric softener, as required

The detergent packaging will have recommendations for how much detergent you should use. The machine holds 7 kg of washing. If you only have a small amount of laundry in the machine, you can reduce the amount of detergent used.

Powder detergent

Pour the powder into the compartment for the main wash, and pre-wash as well if desired.

Liquid detergent

When using liquid detergent, follow the detergent manufacturer's recommendations. We recommend always using a wash ball with very thick liquid detergent.

Wash ball or net

If you use a wash ball or net, place it directly in the drum and select a program without pre-wash.

NOTE!

Detergent overdosing does not give better washing results; it merely causes a greater impact on the environment; can also hinder the wash performance.

Try using less detergent, and increase only if you are not satisfied with the results.

Fabric softener

Pour the fabric softener into the compartment with the  symbol. Follow the recommendations on the fabric softener packaging.

NOTE!

Do not fill above the compartment's maximum fill level. Otherwise fabric softener will run in too early, and will impair washing results.

Washing

5 Select the program

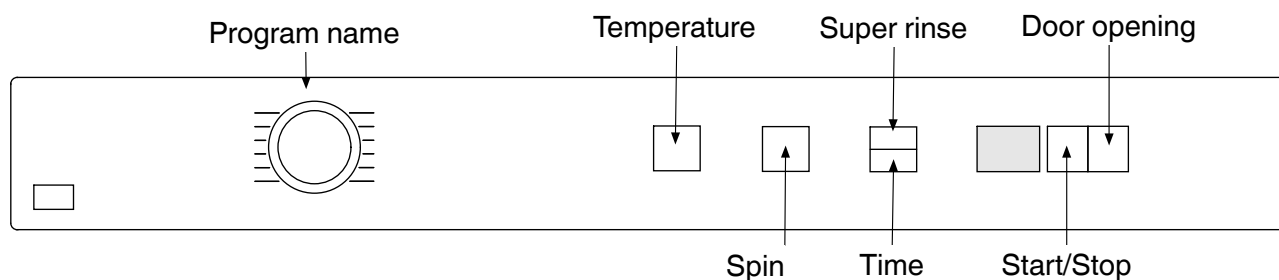

You select a program by turning the program selector. An LED lights up beside the selected program and the estimated program time is shown in the display. The program time is based on the time last taken by the same program. Use the option buttons to select any options.

1. Auto

This program automatically adjusts the length of the main wash and the number of rinses to the amount of laundry loaded in the machine.

2. Heavy

Program for heavily soiled laundry, with dirt that needs to be fully dissolved before the main wash. A pre-wash is used to do this. You can select the temperature freely, so follow the washing instructions for each garment. The highest temperature, 95 °C, is suitable for very heavily soiled laundry. The spin speed can be selected freely. The machine adapts the program time and water consumption to the load size.

3. Normal

Program for normal to heavily soiled laundry, whites and colours. You can select the temperature freely, so follow the washing instructions for each garment. 60 °C is a good temperature for heavily soiled cotton garments, as well as for garments worn next to the skin. Select 40 °C if the laundry is less soiled. The spin speed can be selected freely. The machine adapts the program time and water consumption to the load size.

4. Colour/White

A standard program for lightly to moderately soiled laundry. The temperature can be selected freely, so follow the washing instructions for each garment. Garments worn next to the skin ought to be washed at 60 °C. Very lightly soiled laundry often comes clean already at 40 °C. The spin speed can be selected freely. The machine adapts the program time and water consumption to the load size.

5. Quick

Fast program for laundry that just needs freshening up. The program can be run at any temperature, so follow the washing instructions for each garment. The lower the selected temperature, the shorter the program time. Garments worn next to the skin ought to be washed at 60 °C. The spin speed can be selected freely.

Washing

6. Easy Care

Program for blended materials, permanent press shirts and functional sports clothing. The program has a high water level and as such is also suitable for cushions, quilted jackets and the like. Read the washing instructions carefully and remember, for example, that fabric softener must not be used with the membranes found in some outer garments. A washing temperature up to 60 °C and a spin speed up to 1200 rpm can be selected.

7. Synthetics

Program for delicate fabrics made of synthetic fibres, blended materials or silk. The maximum temperature is 60 °C, but follow the washing instructions for each garment. Many synthetics will come clean at 40 °C. Garments worn next to the skin ought to be washed at 60 °C. The maximum spin speed is 800 rpm.

8. Wool/hand wash

A gentle laundry program for wool, silk and garments that should be washed by hand. The highest temperature is 30 °C. This program has a short spin. The maximum spin speed is 800 rpm.

9. Rinse

This program performs one cold rinse cycle + spin. Suitable for laundry that just needs to be dampened and for cleaning cloths and mops.

10. Spin & Drain

Used to just spin the wash. If you only want to drain the machine of water, select the  symbol (no spin).

Washing

Program chart

Program	Pre-wash	Temp. °C	Number of Rinses	Spin Speed rpm	Max. load (kg)	Water consumption (approx. liter)	Energy consumption (approx. kWh)	Program time (approx. hrs and min.)
1. Auto								
2. Heavy	X	95	5	1400	7	85	2,2	2:45
	X	60	5	1400	7	75	1,2	2:40
3. Normal		60	2	1400	7	60	1,13	3:21
		40	2	1400	7	60	0,47	3:06
4. Colour/White		60	3	1400	7	60	1,1	1:40
5. Quick		40	2	1400	3,5	25	0,4	0:40
6. Easy Care		40	2	1200	3,5	50	0,5	1:20
7. Synthetics		40	3	800	3,5	30	0,4	1:20
8. Wool/hand wash		30	3	800	2,3	70	0,5	0:45
9. Rinse			1	1400	3,5	15	0,1	0:20
10. Spin & Drain				1400	3,5		0,1	0:15

Consumption data may vary from the given values depending on variations in water pressure, water hardness, water inlet temperature, room temperature, fluctuations in the electricity, type and volume of the laundry and any extra options.

Washing

6 Select options

You can select options to adjust the wash program to suit your own specific requirements. The available options depend on the selected program. If the option is available for the selected program, the symbols lights up when you press the button.

The machine will remember the options you select for each program (with one exception – Delayed Start). You can still change the selected options the next time you select the program in question.





Temperature

- Select the temperature by pressing the button until the LED by the desired temperature lights.
- You can select temperatures between 20 °C and 95 °C. For Wool/hand wash you cannot choose a temperature higher than 40 °C, when choosing Synthetics or Easy Care the maximum temperature is 60 °C.



Spin

- Select the spin speed by pressing the button until the LED by the desired speed lights.
- You can select speeds between 400 and 1400 rpm, No spin or No drain. The maximum spin speed varies according to the program selected, so check the LEDs around the button.
- , means that the program does not include a spin cycle and ends by draining.
-  No drain means that the program does not include a spin cycle and ends with the water from the final rinse still in the machine. The washing will remain covered by the water from the final rinse, stopping it from getting creased. If you have selected "No drain", you must select the Spin & Drain program and the  symbol (no spin) once the program has ended to drain the water from the machine before you open the washer door.



Delayed Start

When you select Delayed Start, the machine will start 1–24 hours after you press the Start/Stop button.

- Press the button by the symbol to activate Delayed Start.
- By pressing the button again you can delay the start in whole hours up to a maximum of 24 hours.
- Press Start/Stop, and the machine counts down 1 hour at a time and starts after the selected delay.

If you change your mind and want to cancel Delayed Start, you must press and hold Start/Stop for three seconds.

NOTE!

Remember to press the Start/Stop button to start the program.

NOTE!

Make sure the detergent compartment is completely dry before you add detergent, otherwise there is a risk that the detergent will clump before the machine starts.



Super Rinse

- Select Super Rinse by pressing the button by the symbol.
- An LED next to the button lights when this option is activated.

Washing

7 Close the washer door and press the Start/Stop button Time remaining

When the program starts an estimated program time, in hours and minutes, is displayed. The remaining time is updated three times during the program, based on the actual load and the incoming water temperature. The first update takes place after about 15 minutes. The remaining time is last updated just before the final rinse.

To add or remove washing after the program starts

If you want to add or remove items after the program has started, you can stop the program by pressing and holding the Door opening button (key symbol) for three seconds. The program time flashes on the display. When you restart the machine, add any extra detergent needed and close the washer door. The machine continues automatically from the point where the program was interrupted.

Stopping or changing a program

You can stop a program by pressing the Start/Stop button for three seconds. To restart the machine, select a new program, add any extra detergent needed and press the Start/Stop button.

NOTE!

Do not open the detergent compartment while the machine is running.

8 Once the program has finished Once the program has finished, "End" appears in the display.

The washer door opens automatically once the program has finished. If you want to deactivate the automatic door opening function, see the "Selecting settings" section.

- Remove the load.
- Turn off the main power switch, this will save energy.

If you have small children or pets at home, close the washer door once you have removed the laundry.

Backlighting

Two minutes after the wash program finishes the display backlighting enters energy saving mode.

Settings

You can change the following settings:

Automatic door opening.

Extra rinses.

Door opening

If you choose Automatic door opening the Washer door will open once the program has finished.

1. Turn off the machine using the main power switch.
2. Press and hold the Super rinse button and then switch on the main power switch.
3. 'AdO' is shown on the display if Automatic door opening is activated or 'AdF' if the option has not been activated.
4. Press the Super Rinse button to change the setting.
5. Press the Door opening button to save the setting.

Extra rinses

Upon delivery, your washing machine is set to use three rinses in the Normal and Colour/White programs.

If you want to increase the number of rinses to five for these programs, do as follows:

1. Turn off the machine using the main power switch.
2. Press and hold the Delayed start button and then switch on the main power switch.
3. The display shows "R O" if extra rinses (5 rinses) is activated or "R F" if it is not activated (3 rinses).
4. Turn the program selector to change the setting.
5. Press the Door opening button to save the setting.

Care and cleaning

Cleaning the trap and the drainage pump

The washing machine has a trap where smaller objects such as coins and hairpins can collect. To clean the trap and the drainage pump, do as follows:

1. Make sure the machine is empty of water and switched off at the mains.

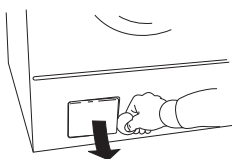

2. Open the door.

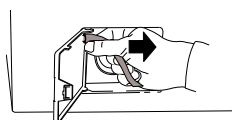

3. Unhook the drainage hose from the connector inside the door and drain the water into a suitable container, such as a shallow bowl.

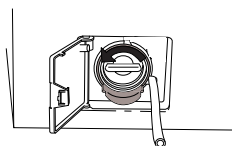

4. Turn the cover anti-clockwise to open the pump. Remove the cover.

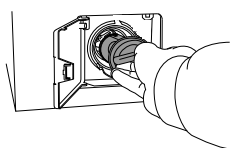

5. Remove any items and so forth from the pump housing and the cover. Also check that the pump blades right at the back rotate.

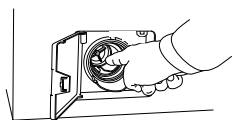

6. Screw on the cover, replace the drainage hose on the hatch pin and close the hatch.

Cleaning the detergent compartment

NOTE!

Do not run the detergent compartment through a dishwasher!

Pull the detergent compartment out as far as it will go.

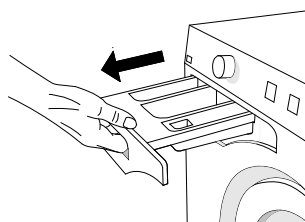

Lift the detergent compartment as you pull it out to remove it from the machine.

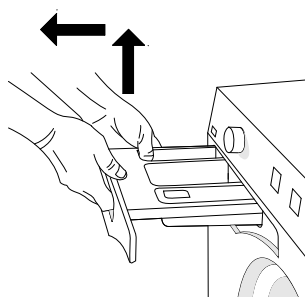

Rinse the compartment and scrub it clean. The fabric softener compartment cover can be removed.

Cleaning the outside of the machine

Clean the outside of the machine and the program panel with a mild cleaner. Do not use any solvents, as these can damage the machine.

NOTE!

Do not hose down the machine with water!

Care and cleaning

Cleaning the inside of the machine to avoid unpleasant smells

Modern detergents often allow clothes to be washed at low temperatures. This means that small deposits can build up in the machine. These, in turn, may lead to unpleasant smells developing; especially if constantly using cold wash.

To avoid this, we recommend running a 95 °C wash program once a month. When you do this, use a small quantity of detergent. It is not necessary to put any washing in the machine.

Care and cleaning

Rinse holes under the agitator

If you suspect that objects such as nails or paper clips may have fallen into the wash drum, you should check the space under the agitator. Such objects can rust and cause spots on clothing. Nails and other sharp objects can cause holes in fabrics.

Do as follows:

1. Insert a screwdriver or the like into the hole on the agitator as illustrated and carefully pry to the left.

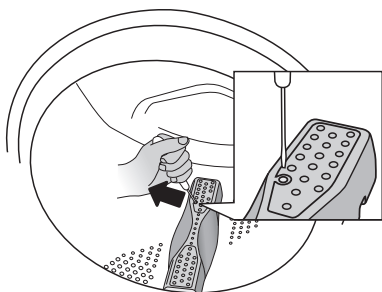

2. Use your other hand to grasp the agitator and pull it towards you.

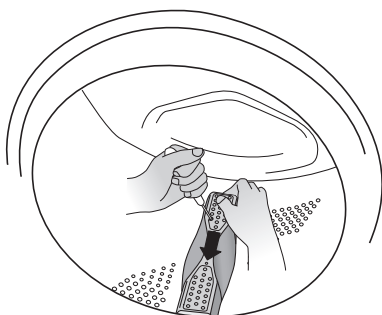

3. Lift the agitator.
4. Remove any objects.
5. Place the agitator in the mounting hole with the F-mark towards you. Ensure that all the agitator fasteners are in their holes in the drum. Push it in until it catches.

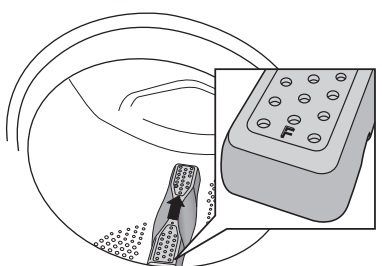

If you have hard water

If you live in an area with hard water (high limescale content), a greyish-white coating may form on the wash drum. To remove this coating, pour approximately 20 gram of citric acid into the wash drum and run any 95 °C program. Repeat if necessary.

Troubleshooting

The washer door will not open

1. Check that the main power switch is on.
2. Is there power? Check your home's fuses (circuit breakers). The washer door cannot be opened with the Door opening button (with the key symbol) if power is off.

If nothing else works, the washer door can be opened as follows:

WARNING!



The door may only be opened manually if the electric power is cut and the machine has been drained of water.

- A Select the Spin & Drain program and the option with the  symbol (no spin) to drain the water from the machine. If this does not work the machine must be drained manually. See "Cleaning the trap and the drainage pump" in the "Care and cleaning" chapter.

If this does not work the machine must be drained manually. See "Cleaning the trap and the drainage pump" in the "Care and cleaning" chapter.

- B Ensure that the main power switch is turned off and that the plug has been removed from the wall socket.
- C Take the emergency door opening tool and place it in the gap on the right side of the washer door lock. This tool is found in the enclosed plastic bag.
- D Push the tool upwards to open the washer door.

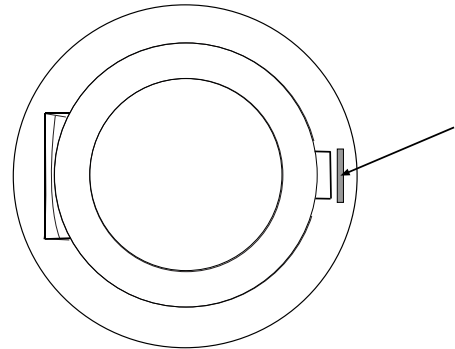

If in the future the washer door does not open when the wash program has finished, call the service division.

The machine will not start

1. Is the washer door properly closed? Push it firmly.
2. Is there power? Check the fuses and residual current devices (circuit breakers) in the building.
3. Check that you have not selected Delayed Start. To cancel Delayed Start, press the Start/Stop button for three seconds.

Troubleshooting

Error messages

If an error occurs during the program a message is shown on the display. To exit the message after taking measures, turn the machine off and then back on.

The error messages that may be shown in the display are:

F10 Overfilling

1. Shut off the water tap.
2. See "Drainage error".

F11 Drainage error

Check:

- that no objects are stuck in the drainage hose outlet.
- that the drainage pump is not blocked by foreign objects. Clean the pump. See the "Care and cleaning" chapter.
- that there are no kinks in the drainage hose.

After taking measures, run the Drain program or press the Door opening button (key symbol) to empty the machine. If this does not resolve the problem, call the service division.

F12 Water inlet fault

Check:

- that the tap on the water pipe is open.
- that the filter in the machine's water inlet is not blocked.

Action:

1. Shut off the water tap.
2. Unscrew the hose.
3. Clean the filter in the inlet valve on the machine.
4. Screw the hose back on.
5. Turn on the tap and check for leaks.
6. Run the program again to check if the fault is fixed.
7. If this does not resolve the problem, call the service division.

≡ ≡ ≡ Imbalance

The machine stops the spin cycle if there is too much imbalance. The washing machine restarts the spin cycle and hopefully the washing is better distributed in the drum. This procedure can be repeated up to 10 times. If the machine still fails to find a good balance, the program jumps to the next step.

The error message requires no action.

Technical information

Technical data

Height:	850 mm
Width:	595 mm
Depth:	585 mm
Weight:	73 kg
Cylinder volume:	60 l
Max. washing capacity:	7 kg
Spin speed (rpm):	400-1400
Rated power:	See type plate.
Heater output:	See type plate.
Water pressure:	0,1-1 MPa 1-10 kp/cm ² 10-100 N/cm ²
Wash drum and liquid compartment material:	Stainless steel
Outer casing material:	Powder-coated and hot-galvanized sheet steel or stainless steel.
Water connection:	1,5 m pex pipe
Drain:	1,7 m polypropylene hose

Information for test institute

Energy declaration

Australian standard:	AS/NZS 2040.1:1998
Washing program:	Normal, 40 °C, 7 kg cotton
Connection:	Cold water 20 °C
Test method for noise measurement:	IEC-60704-2-4

Power requirement when machine turned off	< 0,3 W
Power requirement for Delayed Start	< 6,0 W
Power requirement when program finished	< 3,0 W

Detergent, PBIS and Anti-Sudsing Agent (10ml) must be added via the detergent compartment.

Technical information

Loading procedure for standard test:

When loading the machine for testing according to AS/NZS 2040:2005 it shall be loaded according to the table below. Garments are placed on top of each other in layers and the soil swatches should be placed inside the wash drum in the direction shown in the table, seen from above.

Top	Swatches	Swatch placement
30. Bath towel	1	Left
29. Pillow case	1	Right
28. Pillow case	1	Front
27. Undershorts		
26. T-shirt	1	Rear
25. Tablecloth	1	Right
24. Bath towel		
23. Shirt	1	Front
22. Undershorts	1	Center
21. Undershorts		
20. Sheet	1	Left
19. Wash cloths (all)		
18. T-shirt		
17. T-shirt	1	Center
16. Undershorts	1	Right
15. Shirt	2	Rear
14. Bath towel		
13. Bath towel	1	Left
12. Handkerchiefs (all)		
11. Sheet	1	Right
10. Undershorts		
9. Undershorts	1	Center
8. Shirt	1	Rear
7. Bath towel		
6. Tablecloth	1	Left
5. T-shirt	1	Front
4. Undershorts		
3. Pillow case		
2. Pillow case	1	Left
1. Bath towel	1	Right
Total	20	

Illustration of loaded Wash Drum for standard test.

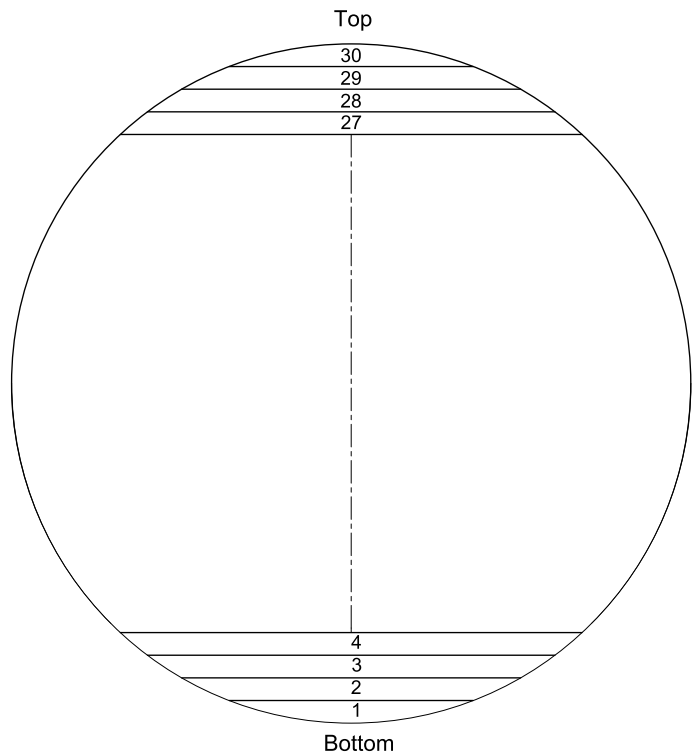

Transport protection

Your washing machine has transport protection of Type A or Type B.

Type A

Before the machine is used, the three transport screws should be removed as shown below.

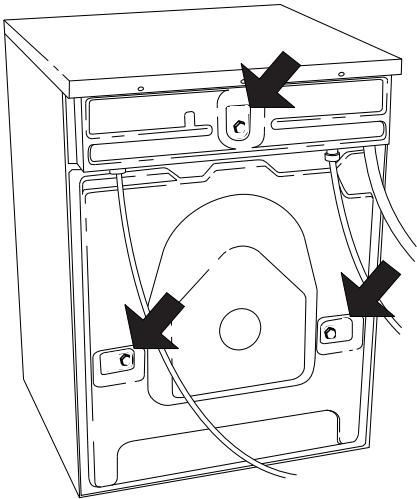

1. Loosen and remove the bolts.

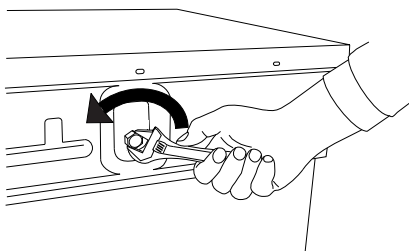

2. The enclosed plastic bag contains three plastic plugs to fit in the empty screw holes.

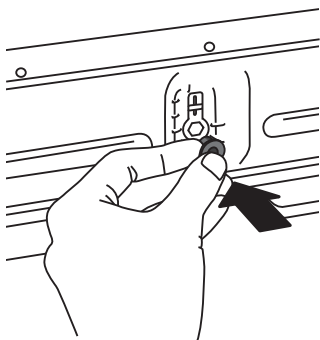

NOTE!

If the machine is to be moved and transported, the transport screws must be refitted to prevent damage to the machine through shaking. If the transport screws or plastic plugs have been lost you can order new ones from your retailer.

Article number	Designation
----------------	-------------

80 882 77	Screw
-----------	-------

80 884 67	Plastic plug
-----------	--------------

Order three of each item!

Transport protection

Type B

Remove the three transport bolts and the plastic plugs for locking the machine for transport before using the machine.

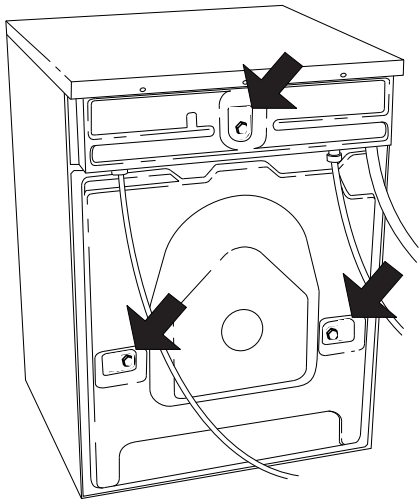

1. Loosen and remove the bolts as illustrated below.

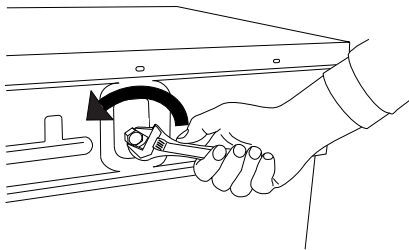

2. To remove the plastic plugs that held the bolts, squeeze together and pull out.

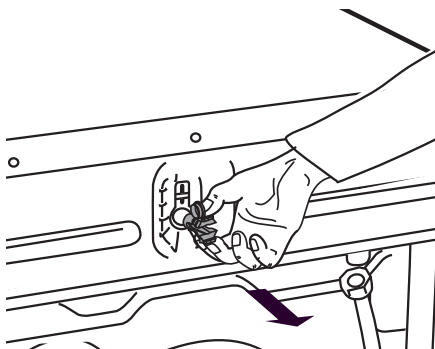

3. Remove the plastic covers from the plugs. Push the plastic covers into the three holes that contained the plugs. Save the plastic plugs in case the machine is moved in the future.

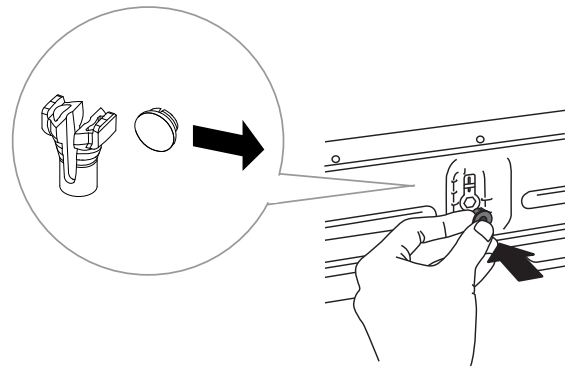

NOTE!

If the machine is to be transported, the bolts and plastic plugs for locking the machine during transport must be installed to prevent damage to the machine through shaking. If the transport bolts or plastic plugs have been lost, you can order new ones from your retailer.

Article number	Designation
80 882 77	Screw
80 901 05	Plastic plug, transport lock

Order three of each item!

Installation

Positioning the washing machine

The washing machine can be installed as a built-in or freestanding unit. Position the machine so that the electrical plug is easily accessible.

A. Built-in

The washing machine can be installed under a counter top with a working height of 850–900 mm. Leave a 5 mm space around the entire machine, including between the rear edge of the top cover and the wall behind it.

B. Freestanding

The washing machine can be positioned beside or under a tumble dryer.

Adjusting the feet

Keep the noise that the machine produces to a minimum by adjusting the feet so that the machine is steady and balanced on the floor. Tighten the lock nuts.

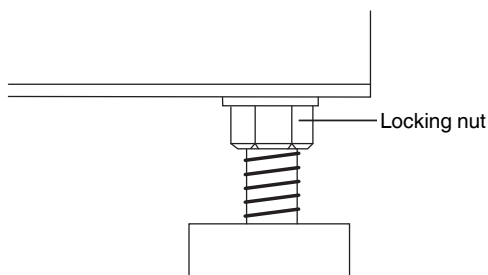

Connection to water supply

Water connection should be carried out by an appropriately qualified person. Connect the machine using the accompanying supply hose. Water pressure should be 0.1–1MPa (approx. 1–10kp/cm²; 10–100N/cm²). There should be a stopcock on the water pipe.

If the pipes are newly installed, it may be wise to flush them through so that any dirt is washed away. Otherwise, dirt can clog the filter in the machine's water intake and cut off or reduce water flow to the machine. Check for leaks.

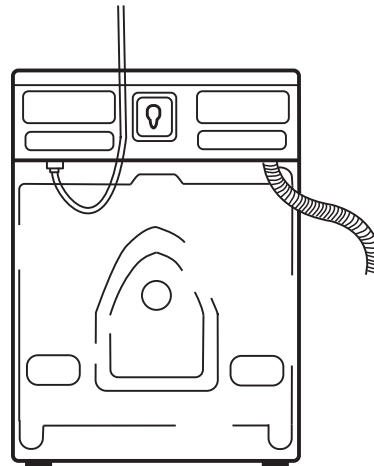

Use only the supply hose supplied with the machine. Do not re-use old hoses or other loose supply hoses.

Installation

Drainage connection

The machine is supplied with a drainage hose attached, which must be connected to a drain. See the examples below. The height must be 600–900 mm above floor level.

The lower position (600 mm) is always preferable. Ensure that the drainage hose has no kinks.

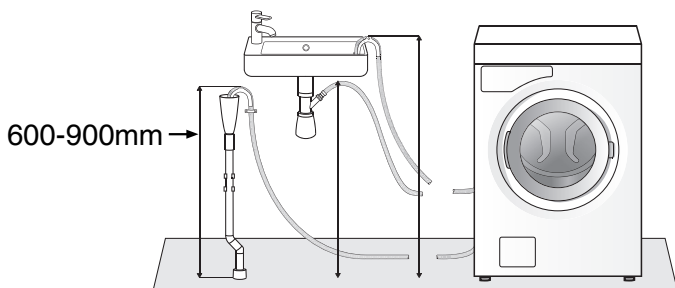

The machine can also be connected to the drain via a spigot connection. In this case the hose should also be 600-900 mm above the floor. The internal diameter of the hole should be at least 18 mm.

- Cut the nipple
- Remove burrs from the hole.

See the illustration.

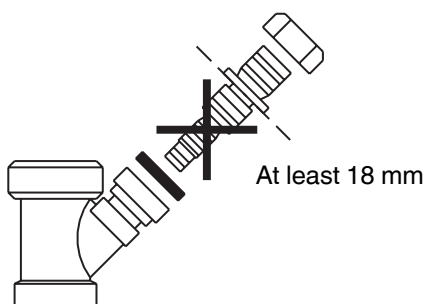

Electrical installation

Connect the machine by plugging it into an earthed wall socket. The electrical wall socket must be placed outside of the installation area to be easily accessible.

CAUTION!

If this appliance is supplied from a cord extensions set or electrical portable outlet device, the cord extension set or electrical portable outlet device must be positioned so that it is not subject to splashing or ingress of moisture.

Connection on delivery

The machine is supplied as 1-Phase, 220-230V, 50-60Hz, heat output 2000W and has a 10A plug. Any residual current devices must be type A.

NOTE!

Repairs and maintenance must be carried out by a qualified professional.

Service

Before contacting the service division

Before you contact the service division, make sure that you know the model number (located on the front panel), and serial number.

The model designation can be found on the panel. The type designation and serial number can be found on the type plate on the inside of the washer door.

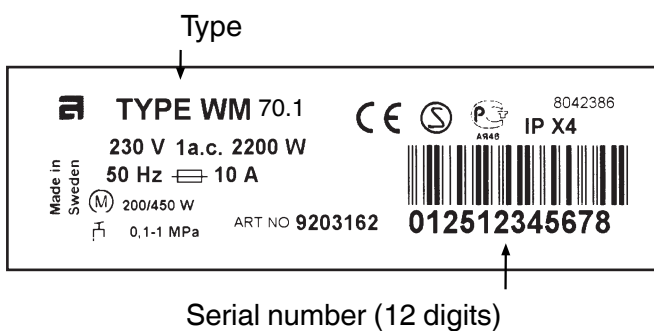
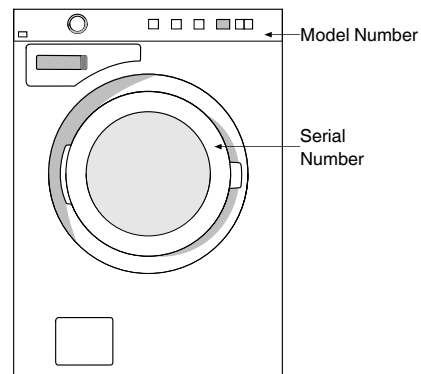

Your notes

Your notes

Quick guide

1 Washing

1. Empty pockets and refasten zips.
2. Read the item's laundry label.
3. Sorting laundry.

NOTE!

Place underwired bras in a laundry net.

2 Load the laundry

1. Press the main power switch.
2. If the washer door is closed, press the Door opening button (key symbol) and the door will open.
3. Load the washing and close the washer door.

3 Detergent compartment

1. Pour detergent into the main wash compartment, and pre-wash compartment as well if required. Pour

fabric softener into the compartment on the right with the -symbol.

2. If you use liquid detergent, follow the detergent manufacturer's recommendations.

4 Select the program

1. Select a program by turning the program selector.
2. Select any options and settings.
3. Press the Start/Stop button.

5 Program finished

1. The text 'End' on the display indicates that the wash program has finished.
2. The washer door opens automatically once the program has finished.
3. Remove the load.
4. Turn off the main power switch.

If you have small children or pets at home, close the washer door once you have removed the laundry.